

TRANSAXLE FLUID TEMPERATURE (TFT) SENSOR INSPECTION

B3E051719010W01

On-Vehicle Inspection

1. Remove the battery cover. (See [BATTERY REMOVAL/INSTALLATION \[ZJ, Z6\]](#).) (See [BATTERY REMOVAL/INSTALLATION \[LF\]](#).)
2. Disconnect the negative battery cable.
3. Remove the under cover.

Caution

- Water or foreign material entering the connector can cause a poor connection or corrosion. Be sure not to drop water or foreign material on the connector when disconnecting it.

4. Disconnect the transaxle connector.

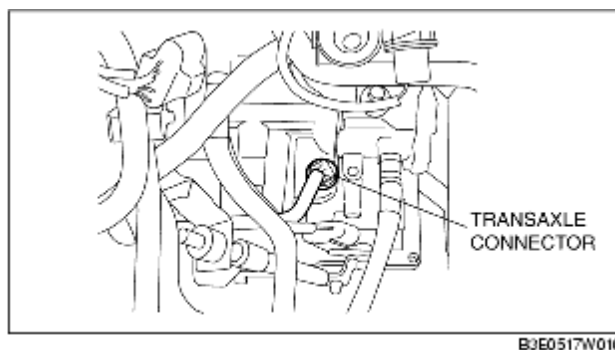

5. Measure the resistance between the transaxle connector terminals E and H.

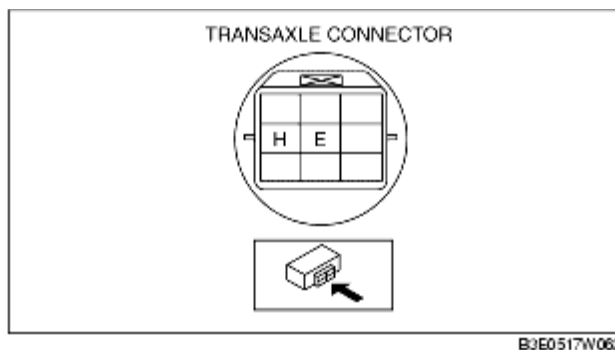

- If there is any malfunction, perform the off-vehicle inspection of TFT sensor. (See [TRANSAXLE FLUID TEMPERATURE \(TFT\) SENSOR REMOVAL/INSTALLATION](#).)

| ATF temperature (°C {°F}) | Resistance (kilohm) |
|---------------------------|---------------------|
| -20 {-4} | 236-324 |
| 0 {32} | 84.3-110 |
| | |

| | |
|-----------|-----------|
| 20 {68} | 33.5-42.0 |
| 40 {104} | 14.7-17.9 |
| 60 {140} | 7.08-8.17 |
| 80 {176} | 3.61-4.15 |
| 100 {212} | 1.96-2.24 |
| 120 {248} | 1.13-1.28 |
| 130 {266} | 0.87-0.98 |

6. Install the under cover.

7. Connect the negative battery cable.

8. Install the battery cover. (See [BATTERY REMOVAL/INSTALLATION \[ZJ, Z6\]](#).) (See [BATTERY REMOVAL/INSTALLATION \[LF\]](#).)

Off-Vehicle Inspection

Warning

- A hot transaxle and ATF can cause severe burns. Turn off the engine and wait until they are cool before replacing the ATF.

1. Remove the control valve body. (See [CONTROL VALVE BODY REMOVAL](#).)
2. Remove the coupler component.

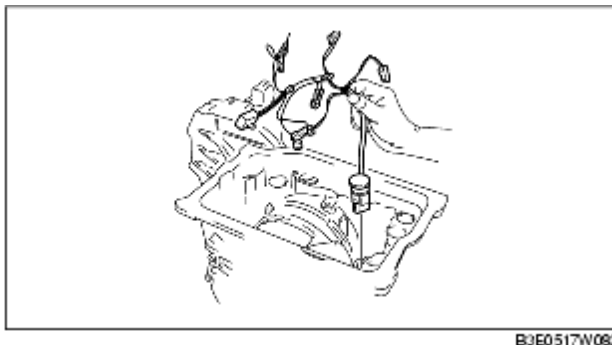

3. Place the TFT sensor and a thermometer in ATF as shown in the figure, and heat the ATF gradually.
4. Measure the resistance between the terminals of the TFT sensor.

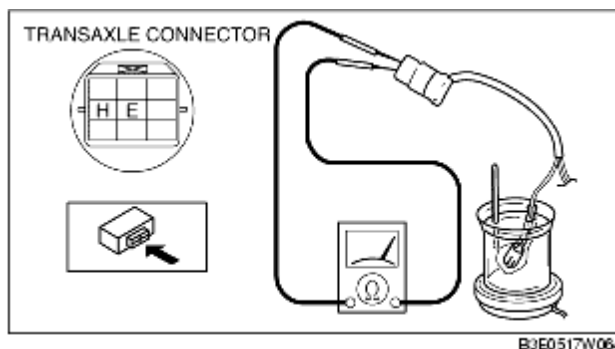

- If there is any malfunction, replace the TFT sensor. (See [TRANSAXLE FLUID TEMPERATURE \(TFT\) SENSOR REMOVAL/INSTALLATION](#).)

| ATF temperature (°C {°F}) | Resistance (kilohm) |
|---------------------------|---------------------|
| -20 {-4} | 236-324 |
| 0 {32} | 84.3-110 |
| 20 {68} | 33.5-42.0 |
| 40 {104} | 14.7-17.9 |
| 60 {140} | 7.08-8.17 |
| 80 {176} | 3.61-4.15 |
| 100 {212} | 1.96-2.24 |
| 120 {248} | 1.13-1.28 |
| 130 {266} | 0.87-0.98 |

5. Install the coupler component.

6. Install the control valve body. (See [CONTROL VALVE BODY INSTALLATION](#).)